

Specifications:  
 Operating Voltage: 250V AC/DC  
 Current Rating: 3A AC/DC  
 Withstand Voltage: 1000V AC/Minute  
 Contact Resistance:  $\leq 30\text{m}\Omega$   
 Insulation resistance:  $\geq 1000\text{m}\Omega$   
 Operating Temperature:  $-25^{\circ}\text{C} \sim +85^{\circ}\text{C}$

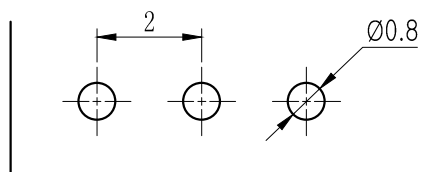
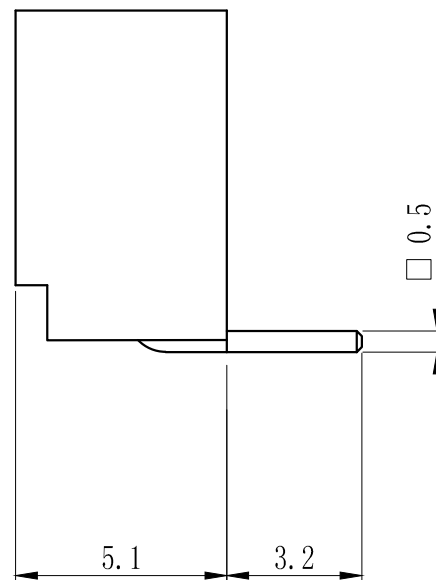
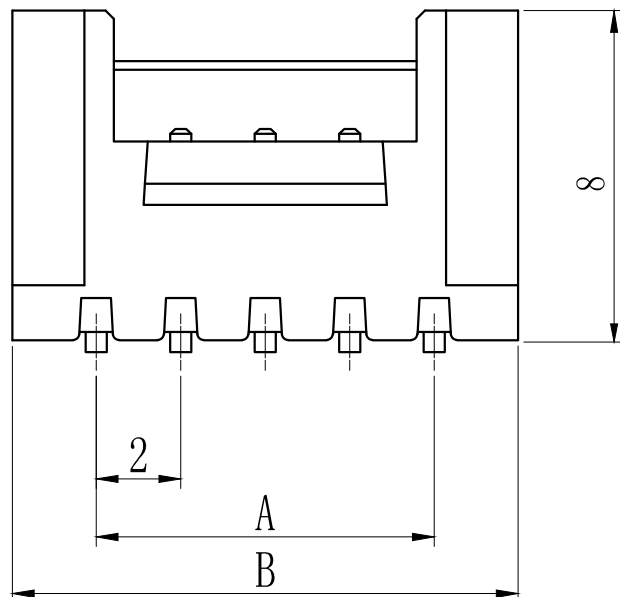

P. C. B LAYOUT

P数	尺寸 (mm)	
	A	B
2	2.00	6.00
3	4.00	8.00
4	6.00	10.00
5	8.00	12.00
6	10.00	14.00
7	12.00	16.00
8	14.00	18.00
9	16.00	20.00
10	18.00	22.00
11	20.00	24.00
12	22.00	26.00
13	24.00	28.00
14	26.00	30.00
15	28.00	32.00
16	30.00	34.00

一般公差 TOLERANCES X. $\pm 0.40$ .XX $\pm 0.20$ .X $\pm 0.30$ .XXX $\pm 0.10$ ANGLES $\pm 2^{\circ}$		<b>深圳市宏利电子有限公司</b> <b>Shenzhen Holy Electronic Co.,Ltd</b>	
检验尺寸标示 SYMBOLS $\odot$ $\ominus$ INDICATE CLASSIFICATION DIMENSION $\odot$ MARK IS CRITICAL DIM. $\ominus$ MARK IS MAJOR DIM.	工程 图号 HY20-nAW 品名 HY2.0-nAW 弯针 TITLE HY2.0mm Pitch AW DIP CONN	制图 (DR) *10/03/22 审核 (CHKD) 核准 (APPD) Rigo Lu	张数 (SHEET) 1 OF 1 尺寸 (SIZE) A4 版本 (REV) 0
表面处理 (FINISH)	比例 (SCALE) 1:1	单位 (UNITS) mm	

修订 REV	修改摘要 REVISION DESCRIPTION	日期 DATE	签名 SIGNATURE
-	-	-	-